

*Our HP200 series relief valves offer a vent to atmosphere relief in a high pressure design.
Factory set and 100% tested for accuracy.*

2M

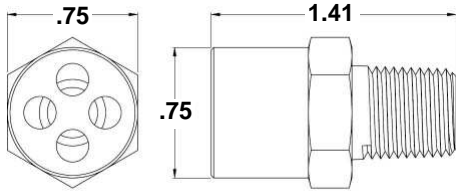

1/4" MNPT x vent	
Max Pressure	600 psi
Orifice size	.290
Flow:	Consult factory
Cracking pressure currently available	150-500 psi

3M

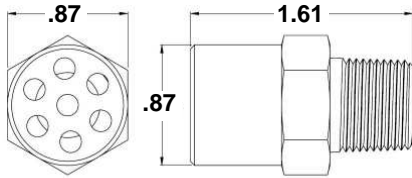

3/8" MNPT x vent	
Max Pressure	600 psi
Orifice size	.360
Flow:	Consult factory
Cracking pressure currently available	150-500 psi

4M

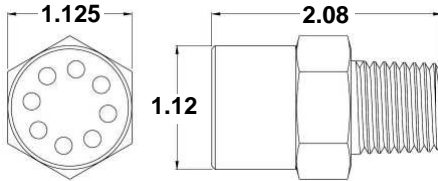

1/2" MNPT x vent	
Max Pressure	600 psi
Orifice size	.430
Flow:	Consult factory
Cracking pressure currently available	150-500 psi

6ST

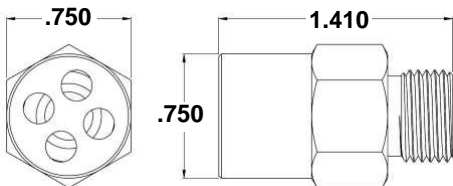

9/16-18 Male x vent Straight thread for o-ring seal	
Max Pressure	600 psi
Orifice size	.290
Flow:	Consult factory
Cracking pressure currently available	150-500 psi

EASY ORDER
the Valve Check way

HP213 - 2 - 2M - 10

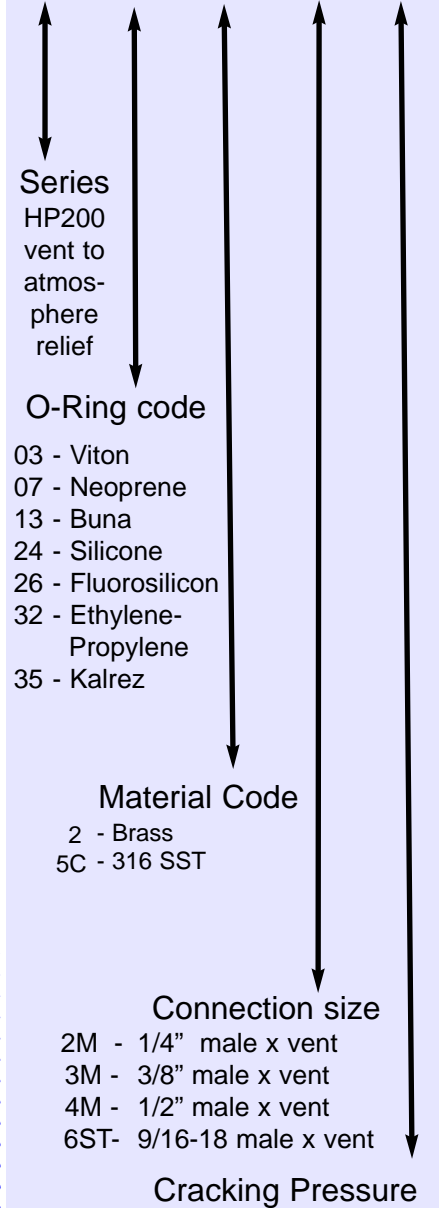

Series
HP200
vent to
atmos-
phere
relief

O-Ring code

- 03 - Viton
- 07 - Neoprene
- 13 - Buna
- 24 - Silicone
- 26 - Fluorosilicon
- 32 - Ethylene-Propylene
- 35 - Kalrez

Material Code

- 2 - Brass
- 5C - 316 SST

Connection size

- 2M - 1/4" male x vent
- 3M - 3/8" male x vent
- 4M - 1/2" male x vent
- 6ST- 9/16-18 male x vent

Cracking Pressure

Valve Check part # description:

- HP200 series, Buna o-ring,
- Brass
- 1/4 inch male x vent
- Cracking pressure: 10 psi

◆ **Standard set pressure tolerance is +/- 5%**

◆ **Temperature range will vary by body and o-ring material**

◆ **Other options may be available or created:
tighter tolerances, materials, plating, threads and more**

We encourage customization to meet specific applications needs