

*Our HP200 series relief valves offer a vent to atmosphere relief in a high pressure design.
Factory set and 100% tested for accuracy.*

2M

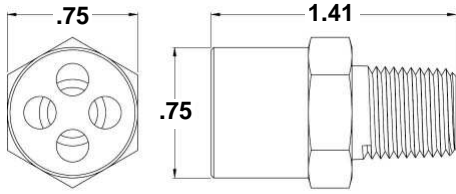

1/4" MNPT x vent	
Max Pressure	600 psi
Orifice size	.290
Flow:	Consult factory
Cracking pressure currently available	150-500 psi

3M

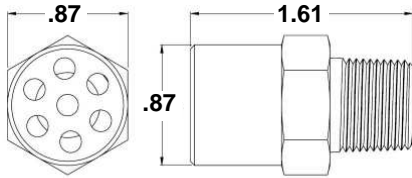

3/8" MNPT x vent	
Max Pressure	600 psi
Orifice size	.360
Flow:	Consult factory
Cracking pressure currently available	150-500 psi

4M

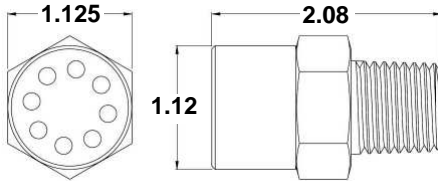

1/2" MNPT x vent	
Max Pressure	600 psi
Orifice size	.430
Flow:	Consult factory
Cracking pressure currently available	150-500 psi

6ST

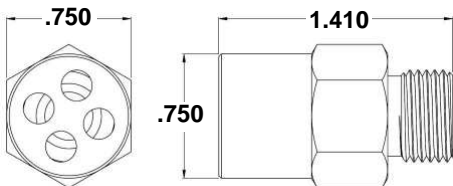

9/16-18 Male x vent Straight thread for o-ring seal	
Max Pressure	600 psi
Orifice size	.290
Flow:	Consult factory
Cracking pressure currently available	150-500 psi

EASY ORDER
the Valve Check way

HP213 - 2 - 2M - 10

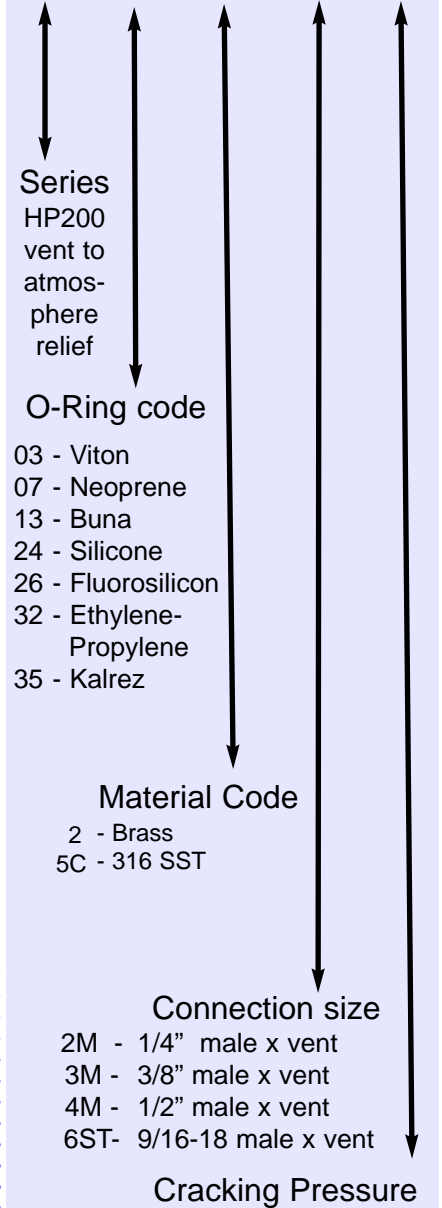

Valve Check part # description:

- HP200 series, Buna o-ring,
- Brass
- 1/4 inch male x vent
- Cracking pressure: 10 psi

◆ **Standard set pressure tolerance is +/- 5%**
 ◆ **Temperature range will vary by body and o-ring material**
 ◆ **Other options may be available or created:
 tighter tolerances, materials, plating, threads and more**
We encourage customization to meet specific applications needs